



shells1

lkarao®

QUICK START GUIDE

WHAT'S IN THE BOX

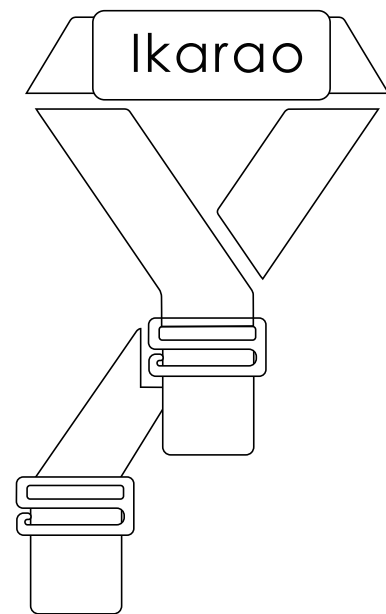

CARRYING STRAP



SHELL S1

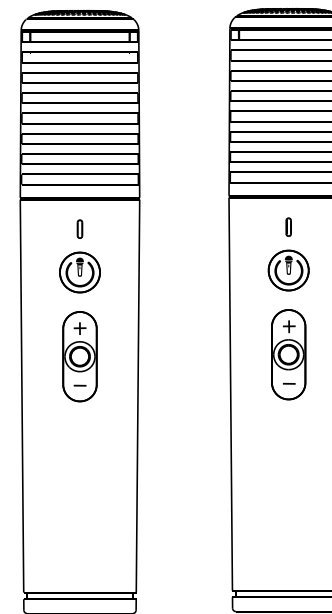

TWO WIRELESS MICS

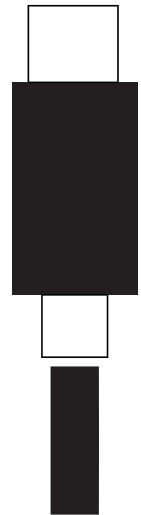

TYPE-C CABLE

BUTTON

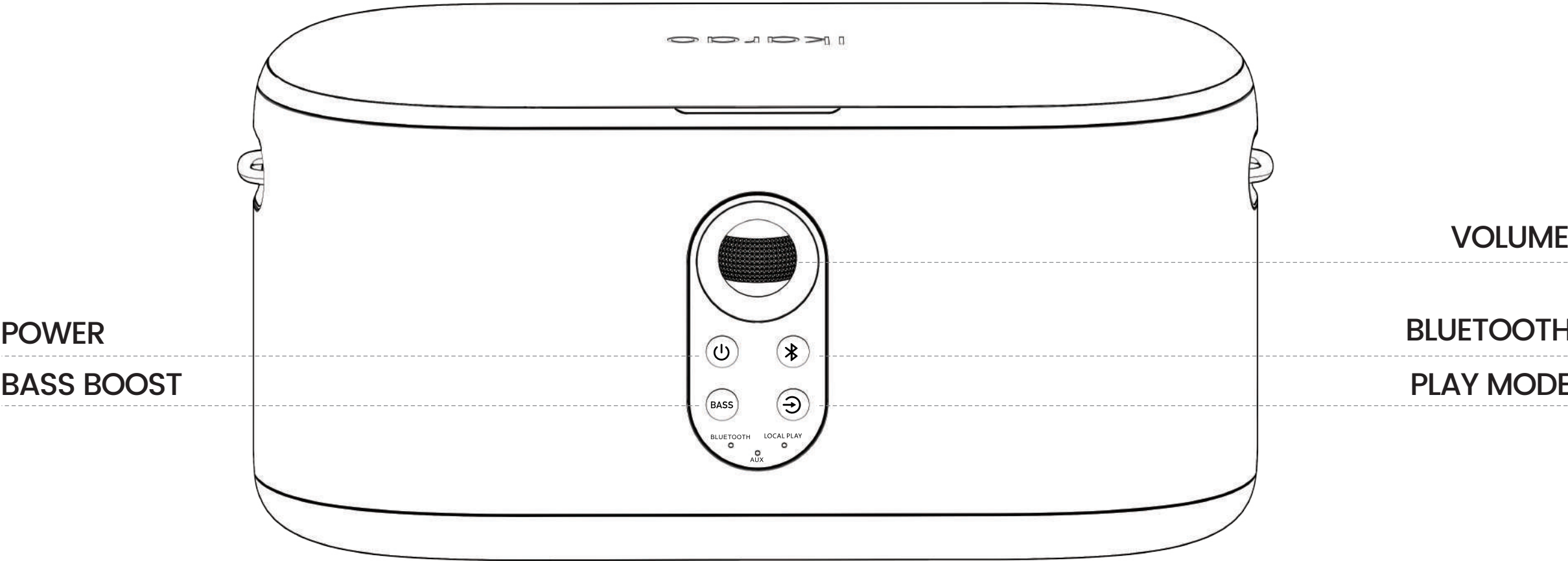

INTERFACES

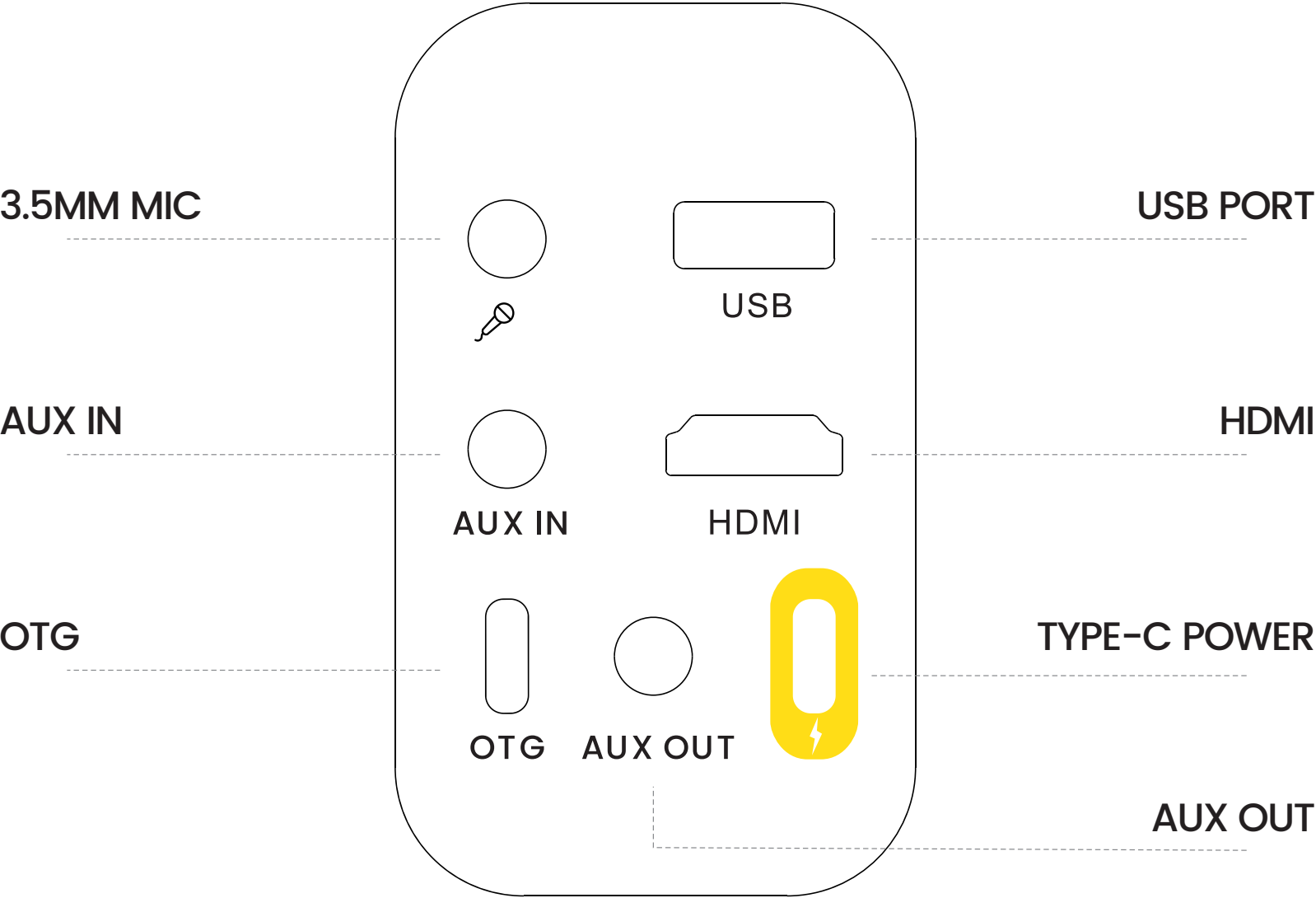

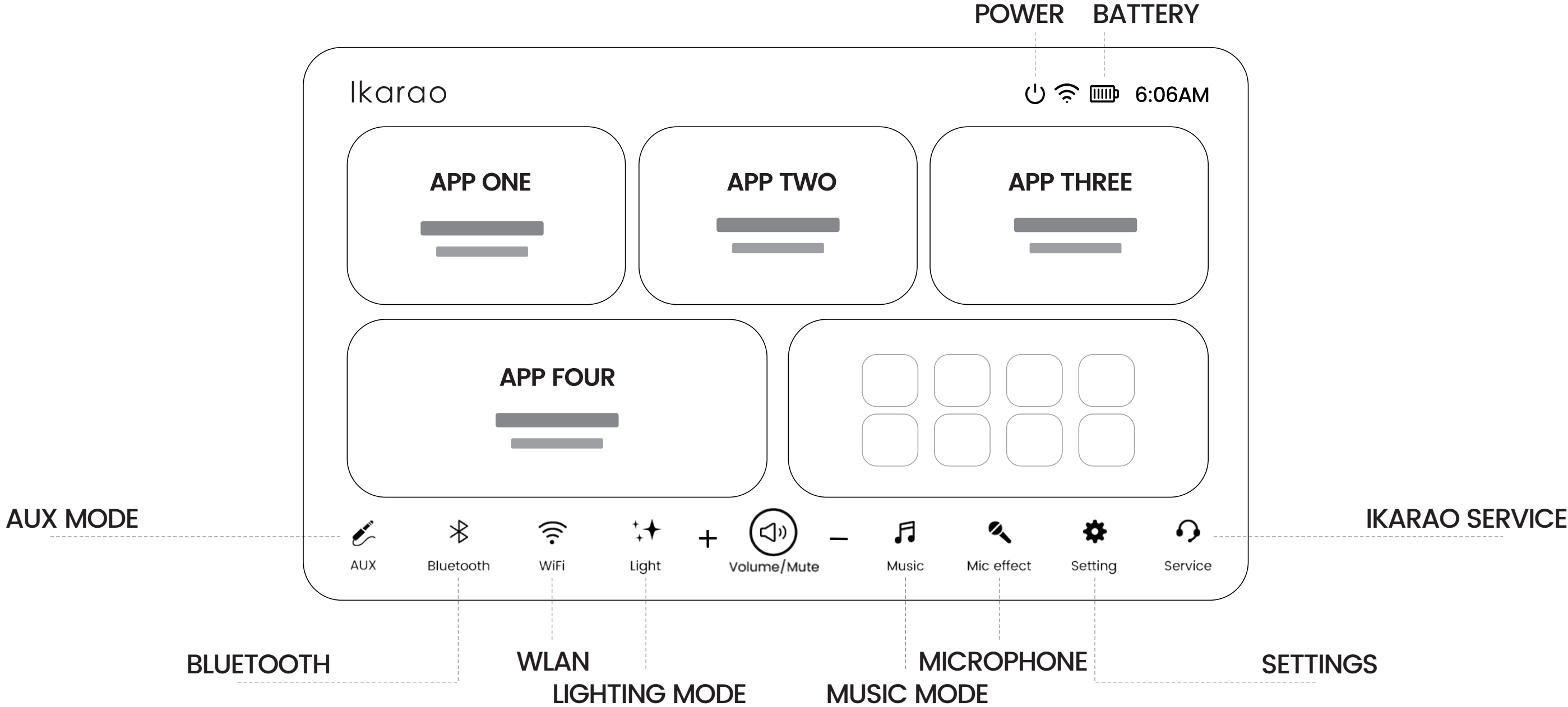

HOMEPAGE





LIGHTING EFFECT

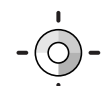

Power/Volume Indicator:

-  **POWERING ON**
*WHITE LIGHT SPINS ONCE PER SECOND.
-  **VOLUME+/-**
*VOLUME INCREASES, LIGHT INTENSIFIES

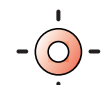
Charging Indicator:

-  **LOW BATTERY**
*SLOW FLASHING
-  **CHARGING**
*BREATHING
-  **FULLY CHARGED**
*OFF

Bluetooth/Playback Indicator:

-  **PAIRING**
*FAST FLASHING
-  **CONNECTED**
*BLUE LIGHT ON FOR 3S THEN REVERTS.
-  **PLAYING MUSIC**
*ROMANTIC/DYNAMIC/LIGHT

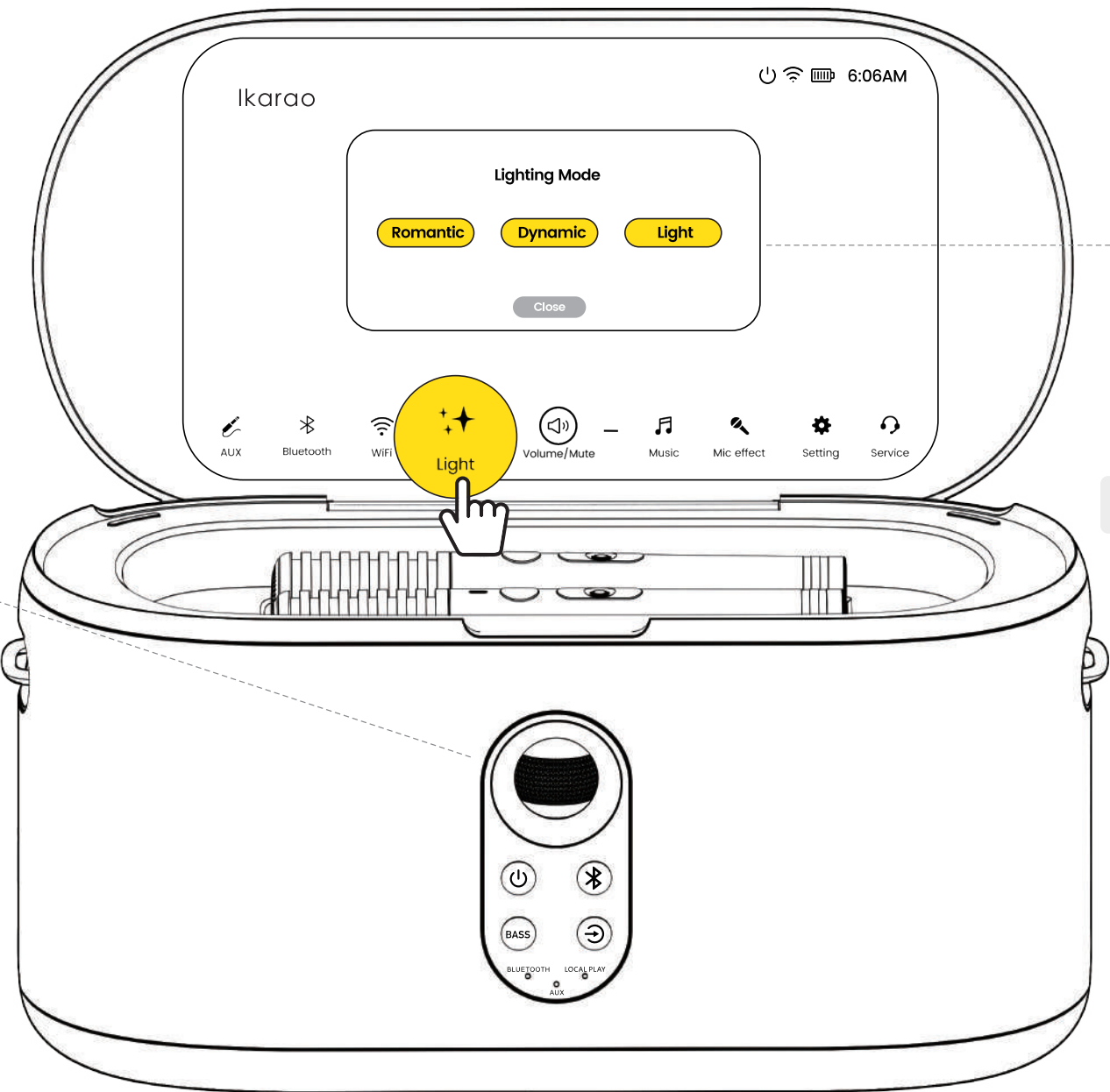

Select the preferred light

BLUETOOTH AUDIO

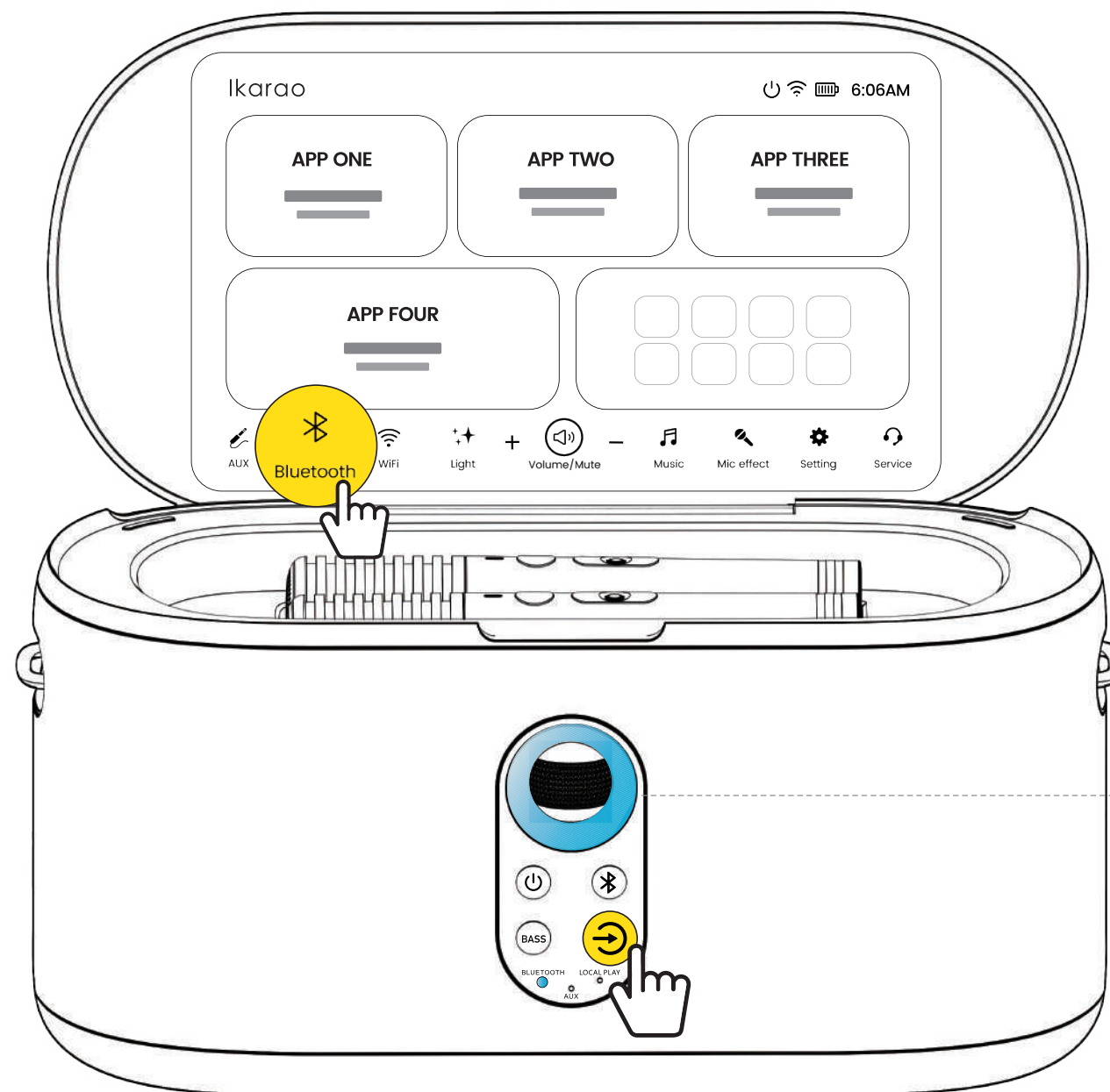
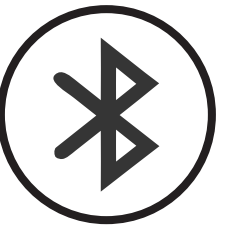

- 1 Press the **Bluetooth** button on the screen or press the playback mode button to switch into Bluetooth mode.

The lights will flash blue

- 2 Open the Bluetooth settings on your device and pair with 'IKARAO S1-XXXX'

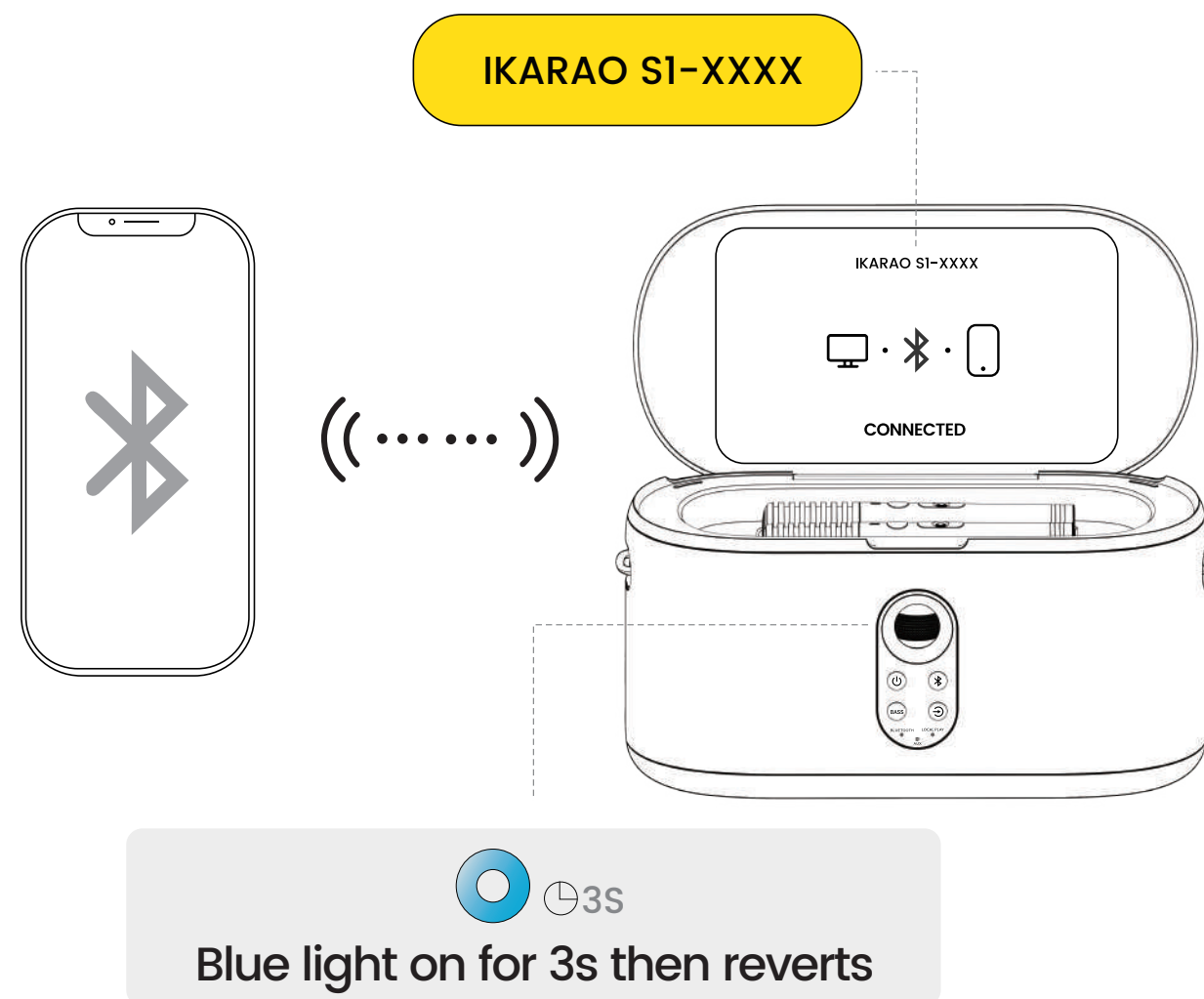

- 3 Press the Bluetooth button to disconnect

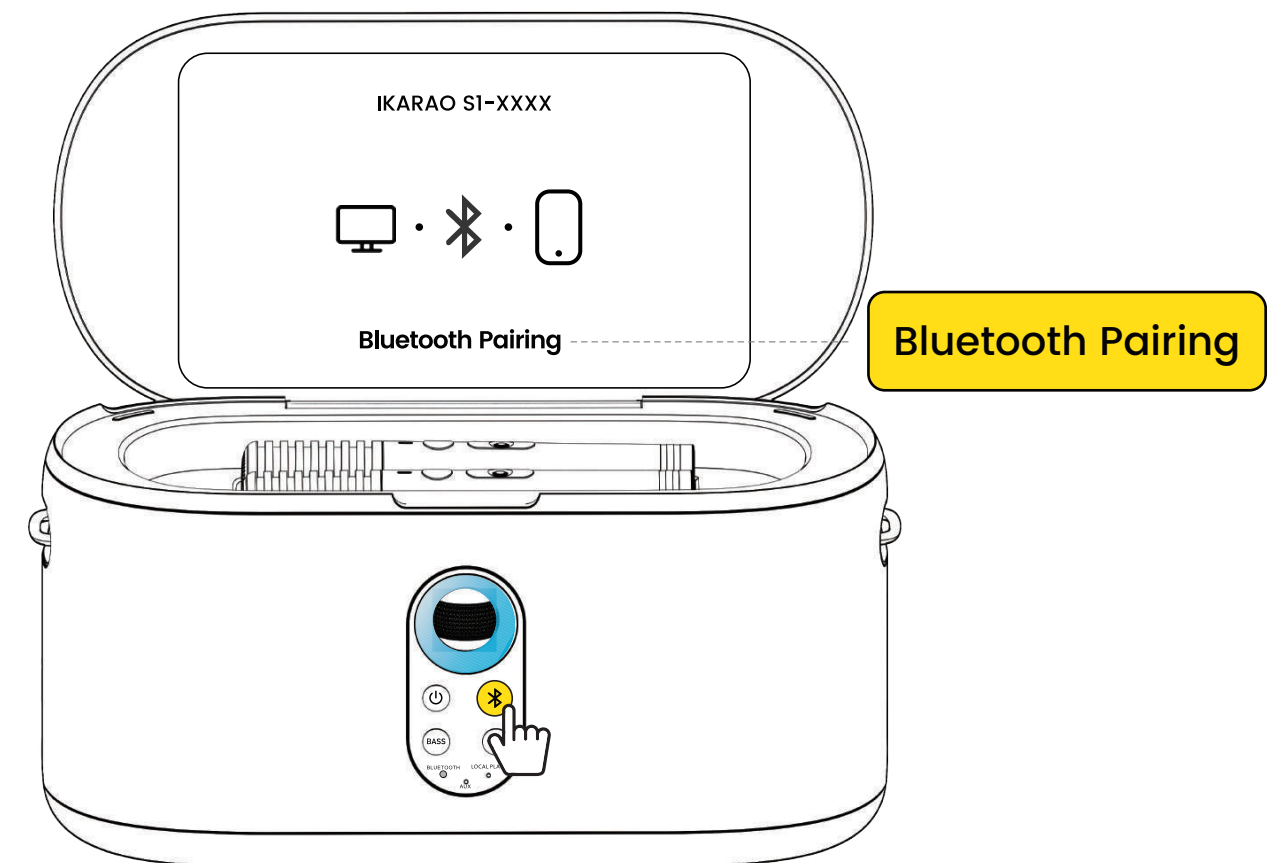

LOCAL AUDIO

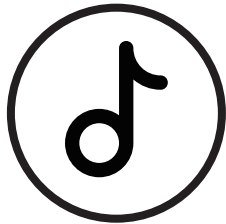

1 Insert a USB with audio/video files

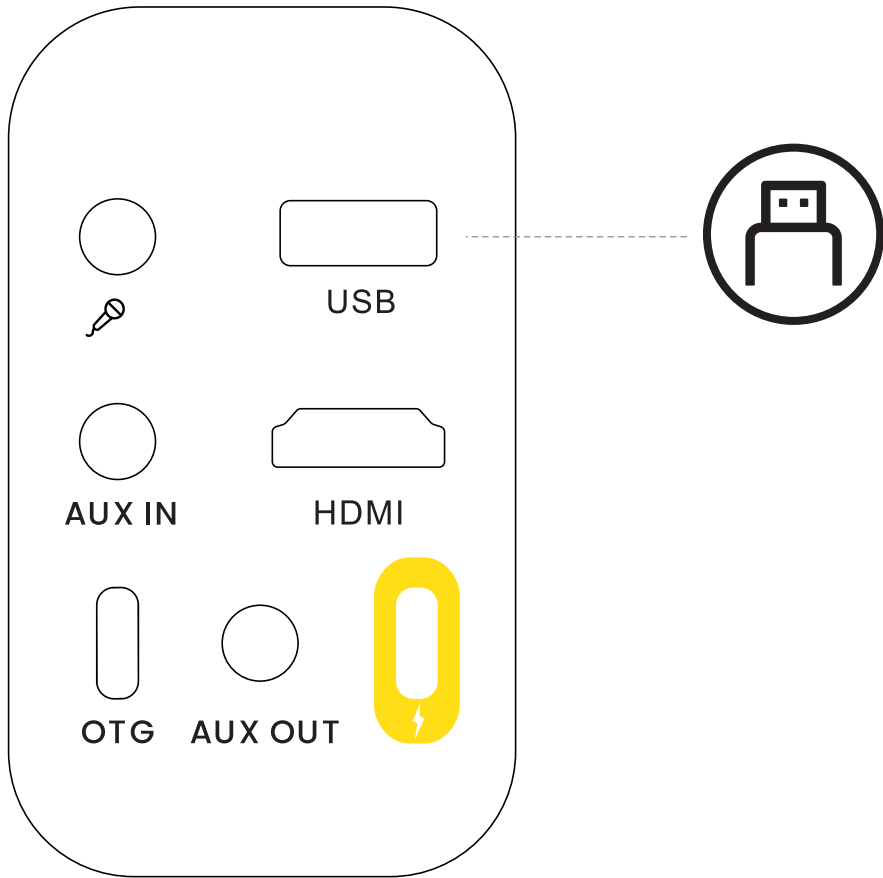

2 Click **Yes** on the screen prompt to enter the local media player

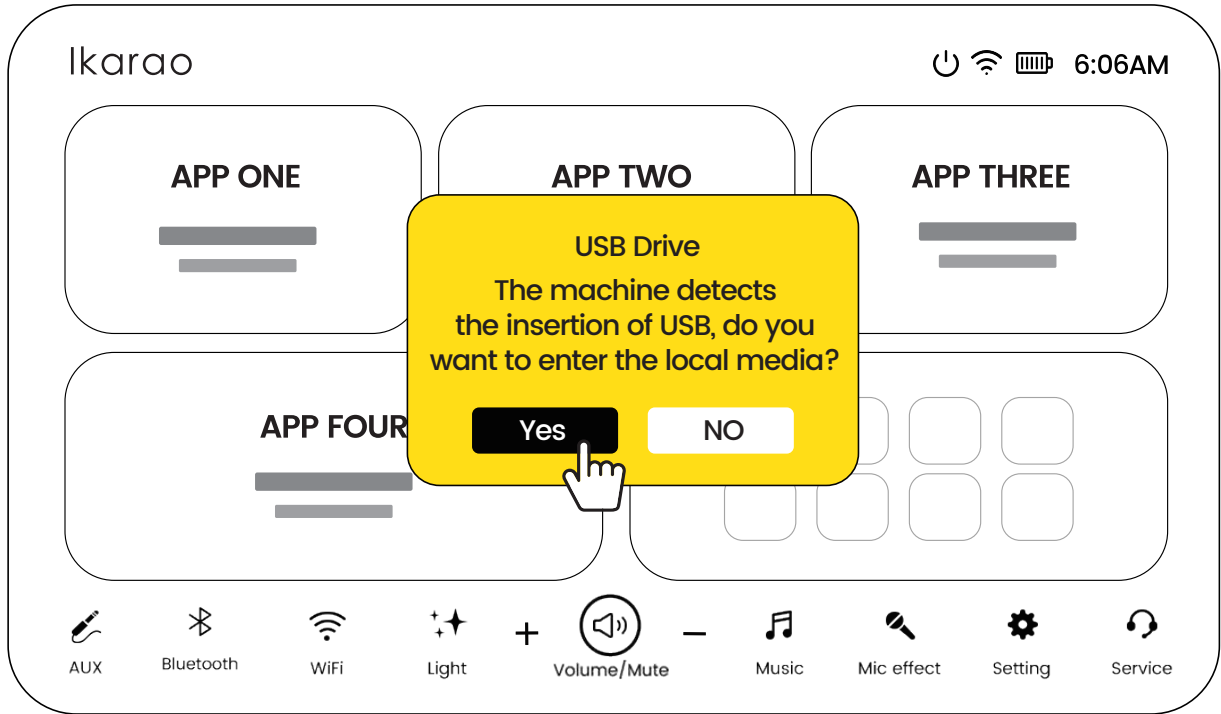

- 3 If you accidentally click **NO**,
re-enter the local media player by selecting **LOCAL MEDIA** .

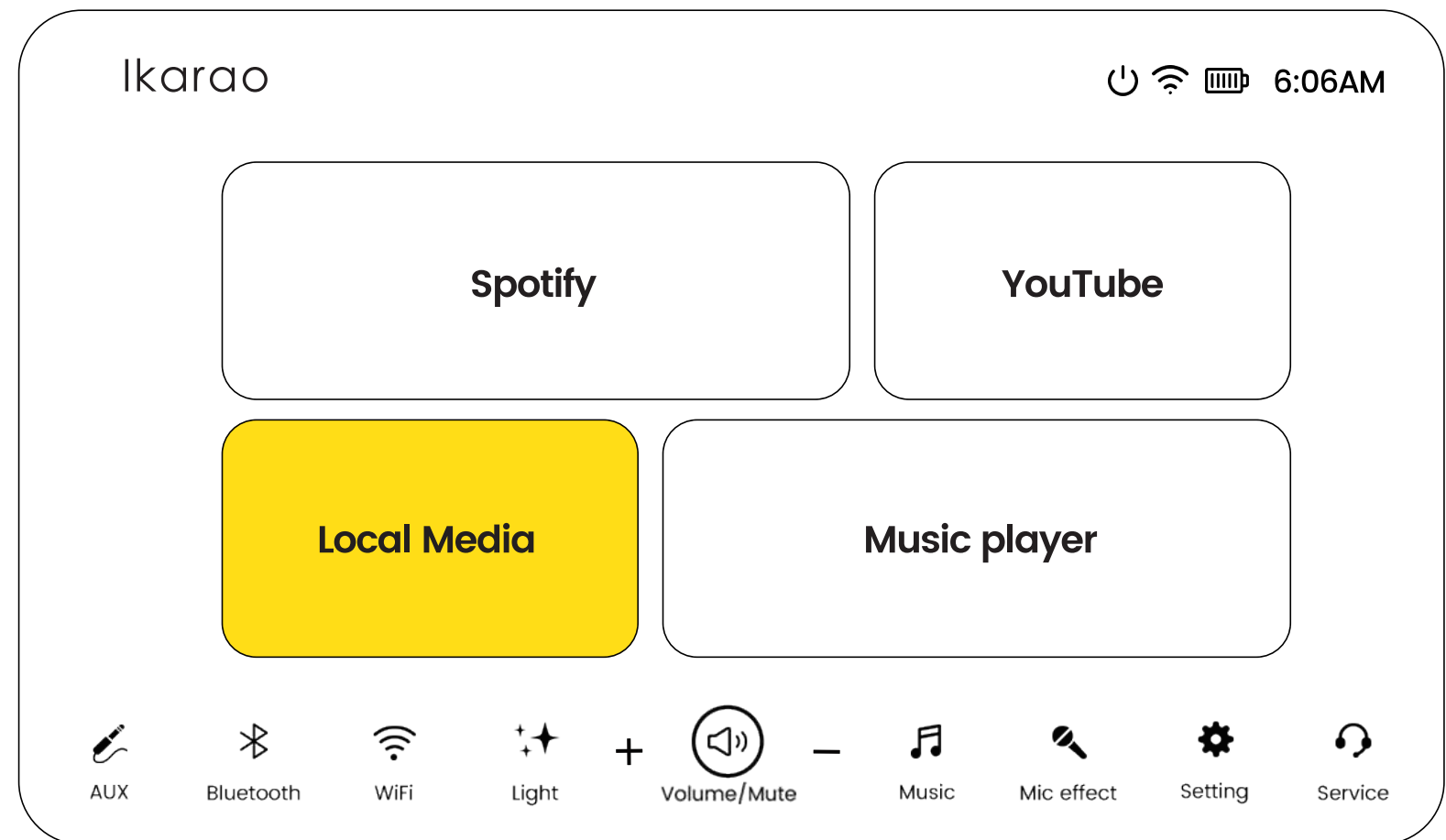

NOTE: Local Media Player auto-loads .LRC lyrics from the same directory as audio files.

HDMI



1 Connect using HDMI cable

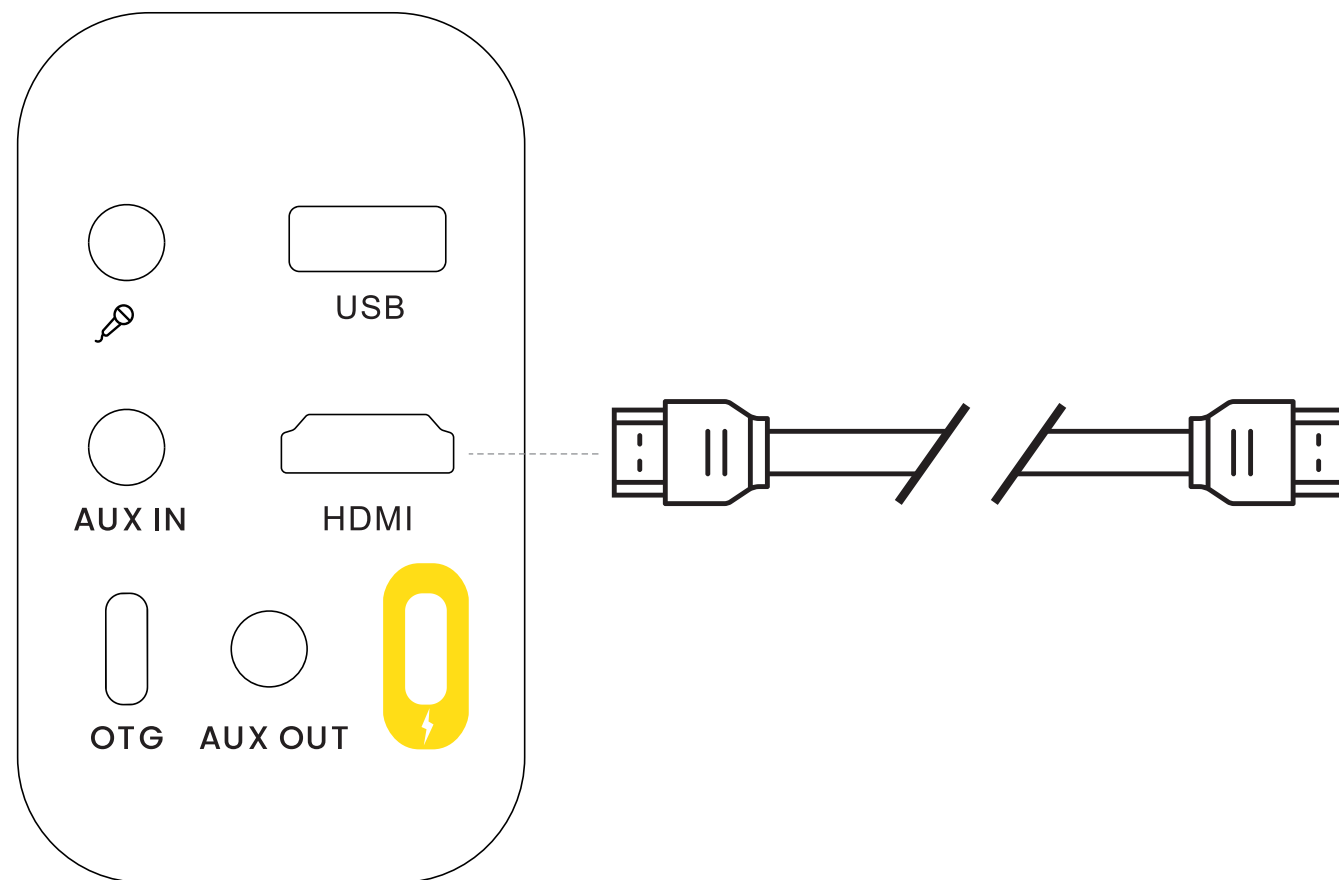

2 Select the HDMI input source to confirm connection

WI-FI AUDIO



1 Click **Settings**

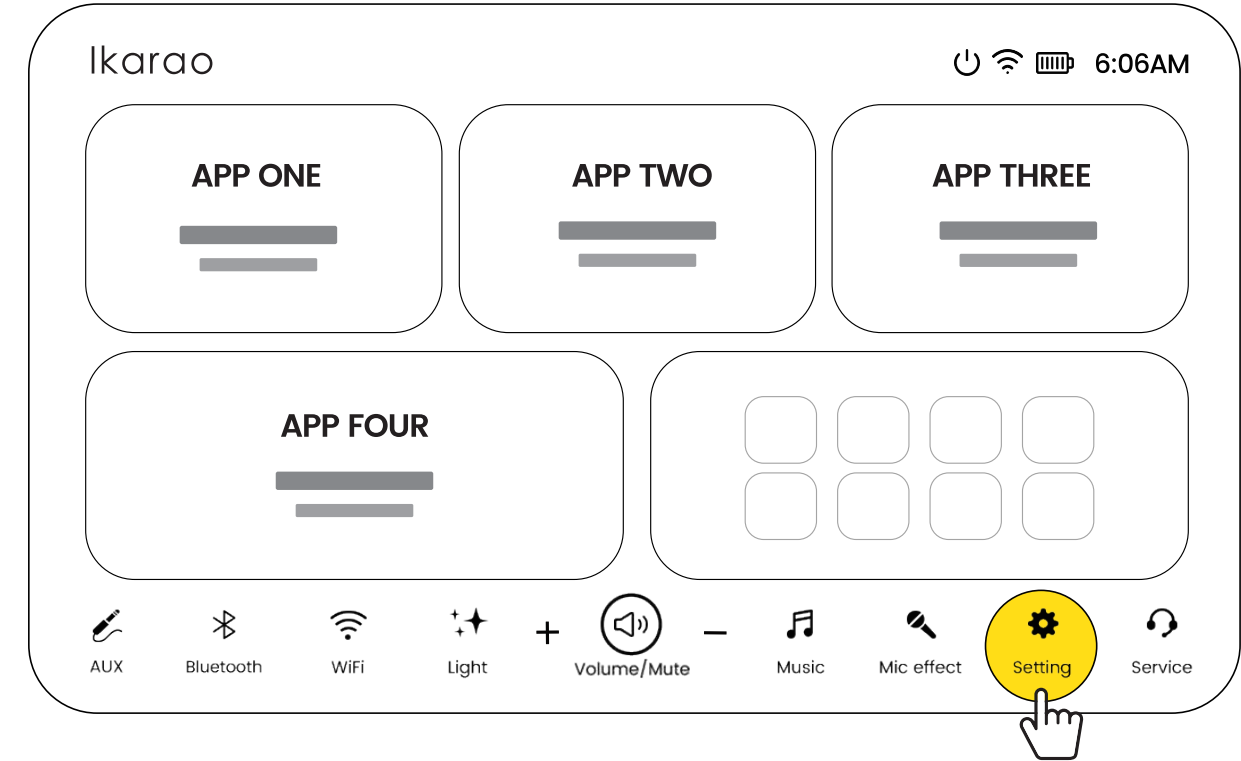

2 Connect Your Wlan

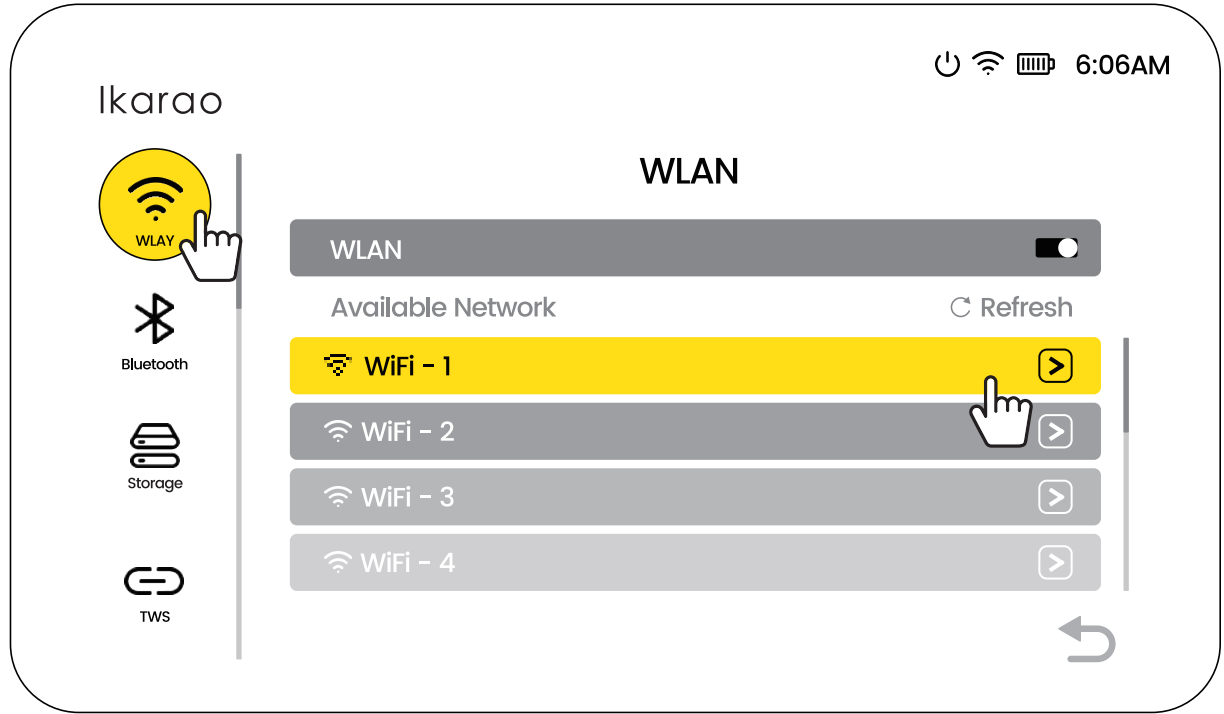

MICROPHONES



- 1 Hold the power button for 2 seconds to turn on



- 2 The mic auto-pairs with the speaker



3 Use buttons to switch effects, adjust volume, and play/pause.

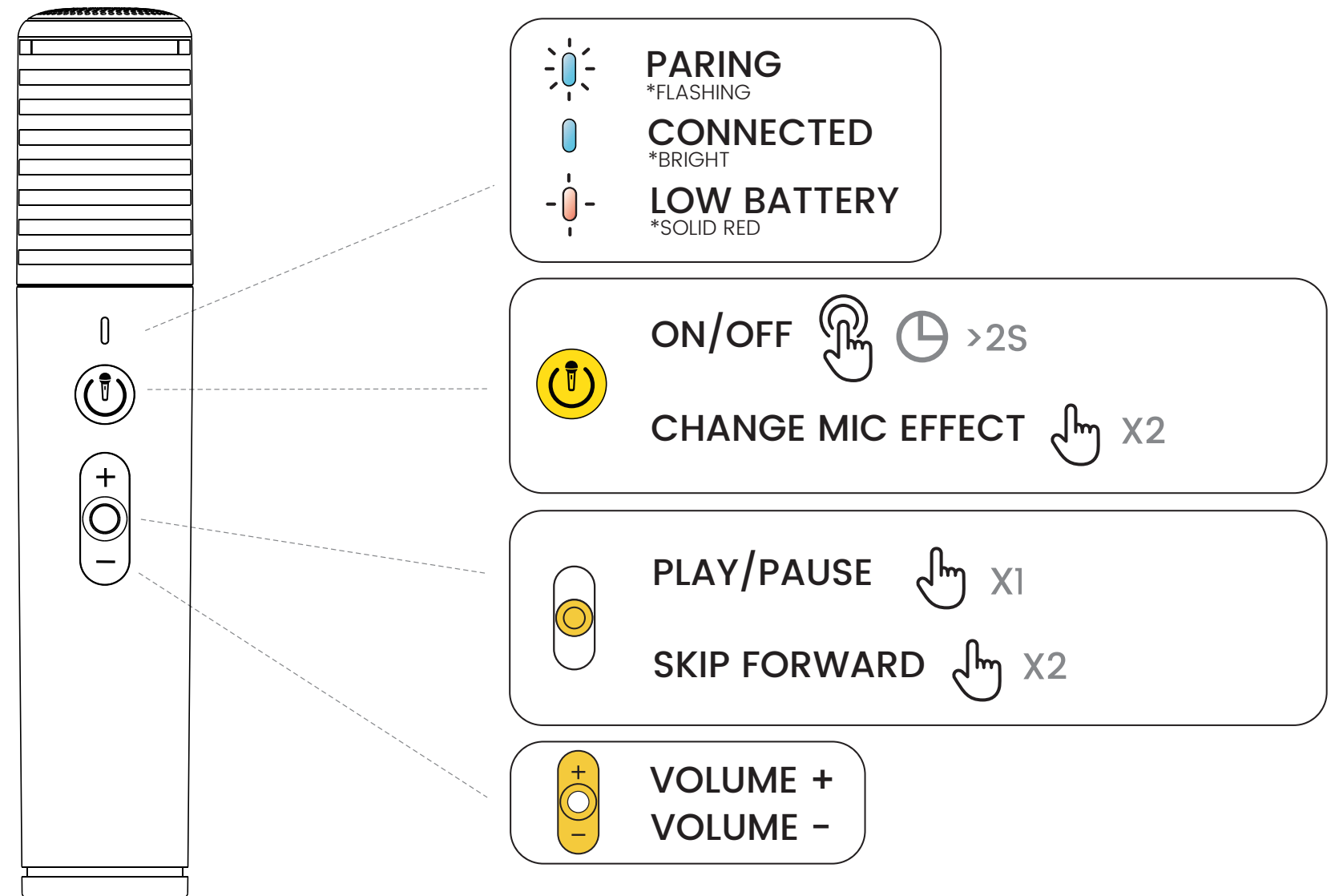

NOTE: Don't point the mic at the speaker to avoid interference.

This operation will differ due to the version difference.(Skip forward: Long press>2S)

SPEAKER CHARGING

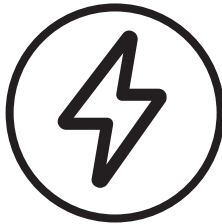

1 Charge speaker with Type-C cable



Type-C

2

LOW BATTERY
*SLOW FLASHING

CHARGING
*BREATHING

FULLY CHARGED
*OFF

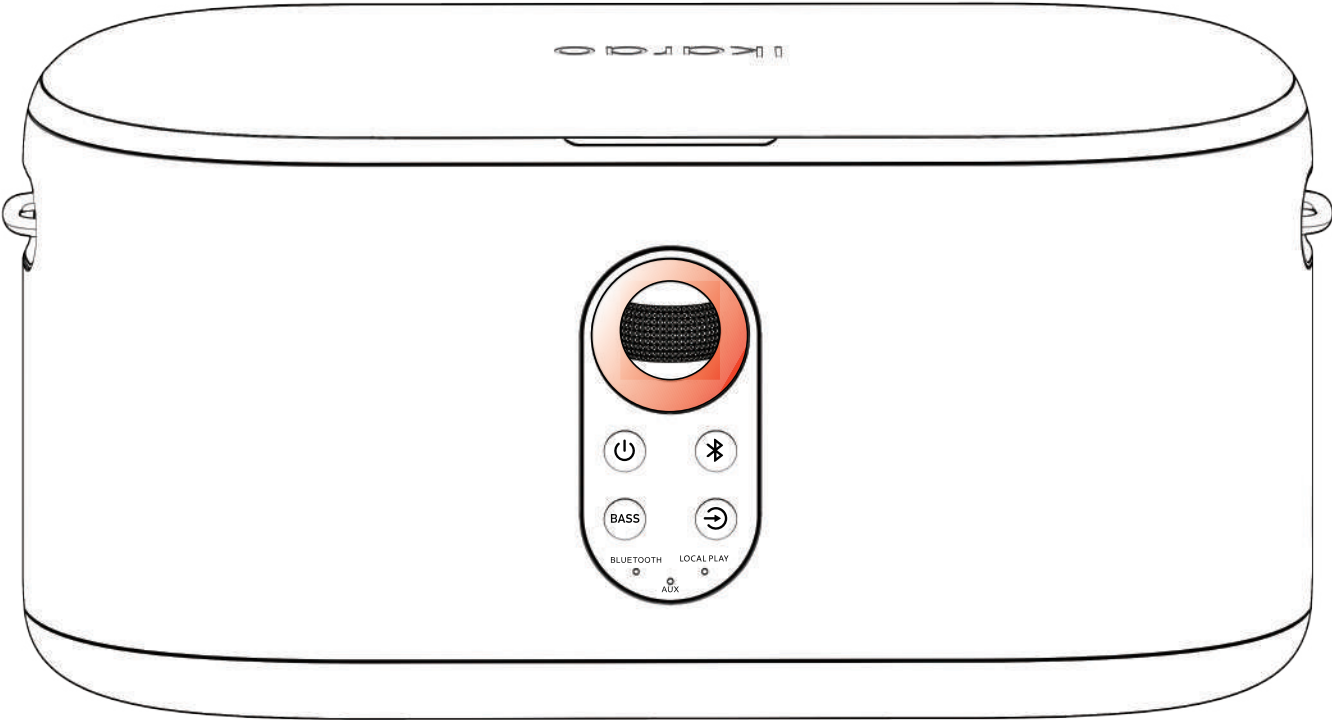

NOTE: Cable included, no adapter. Use a 45W adapter for fast 3-hour charging.

MICROPHONES CHARGING

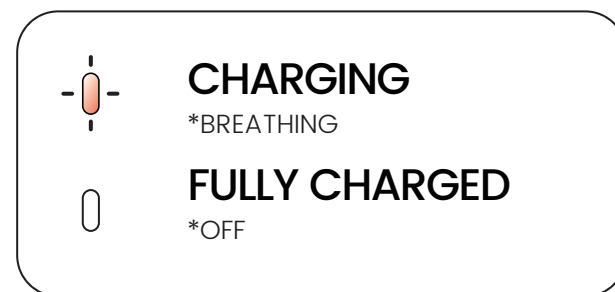

Place mics in magnetic charging slot

NOTE:

1. Microphone has a 20-hour usage duration with a 5-hour full charge time.
2. The speaker stops charging the microphone in low power mode (around two battery bars).

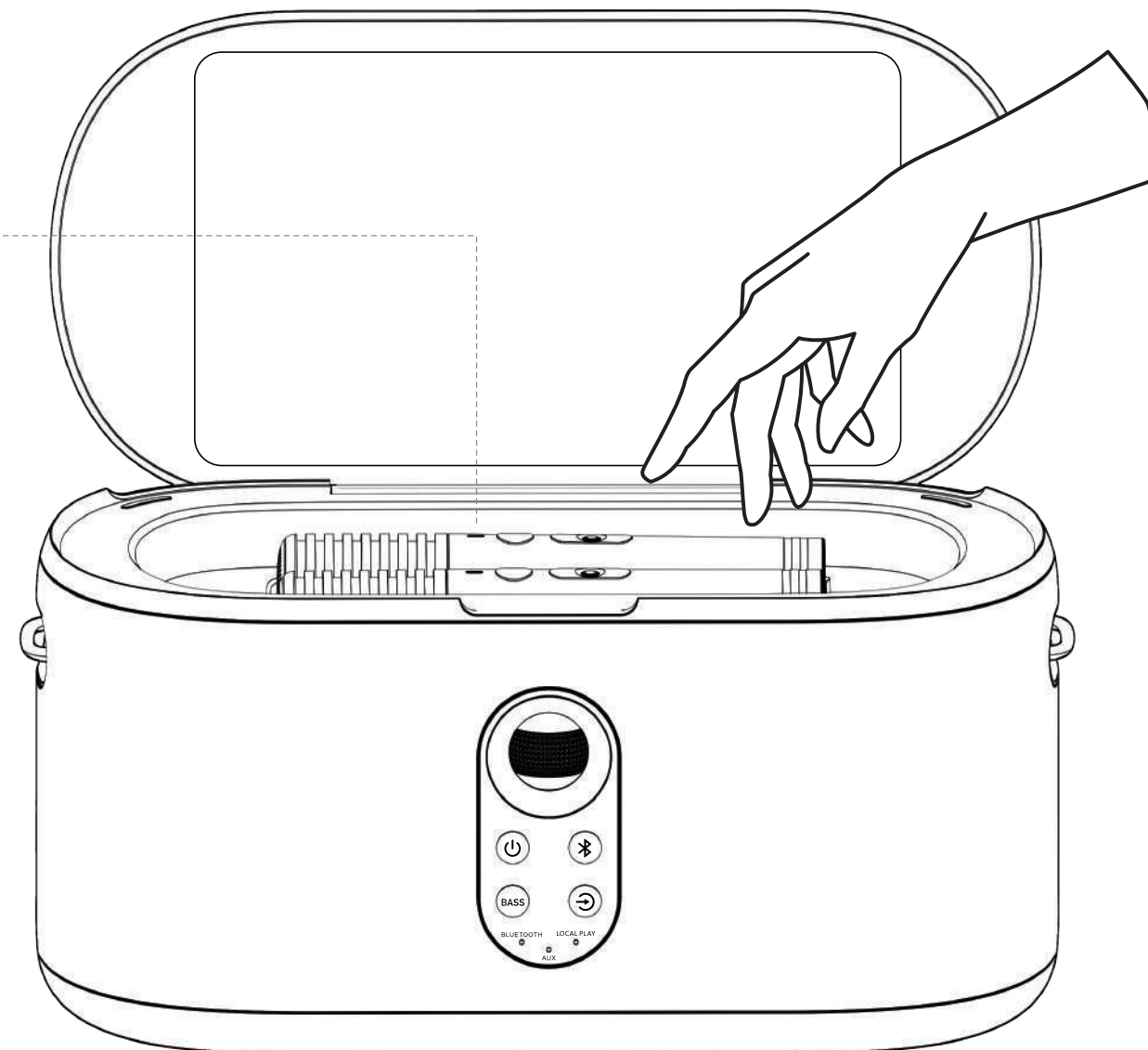

SOFTWARE UPDATE

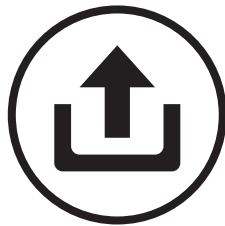

1 Click **Settings**

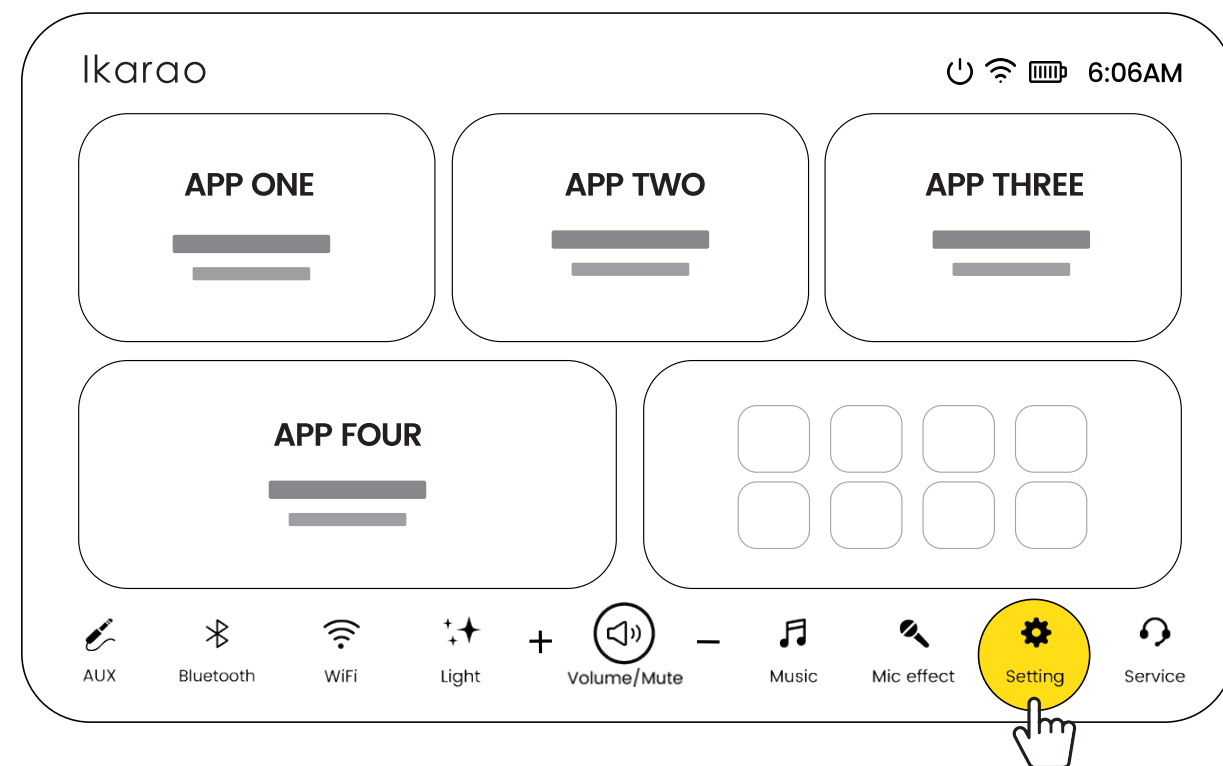

2 Click **Detect New Version** on **About**

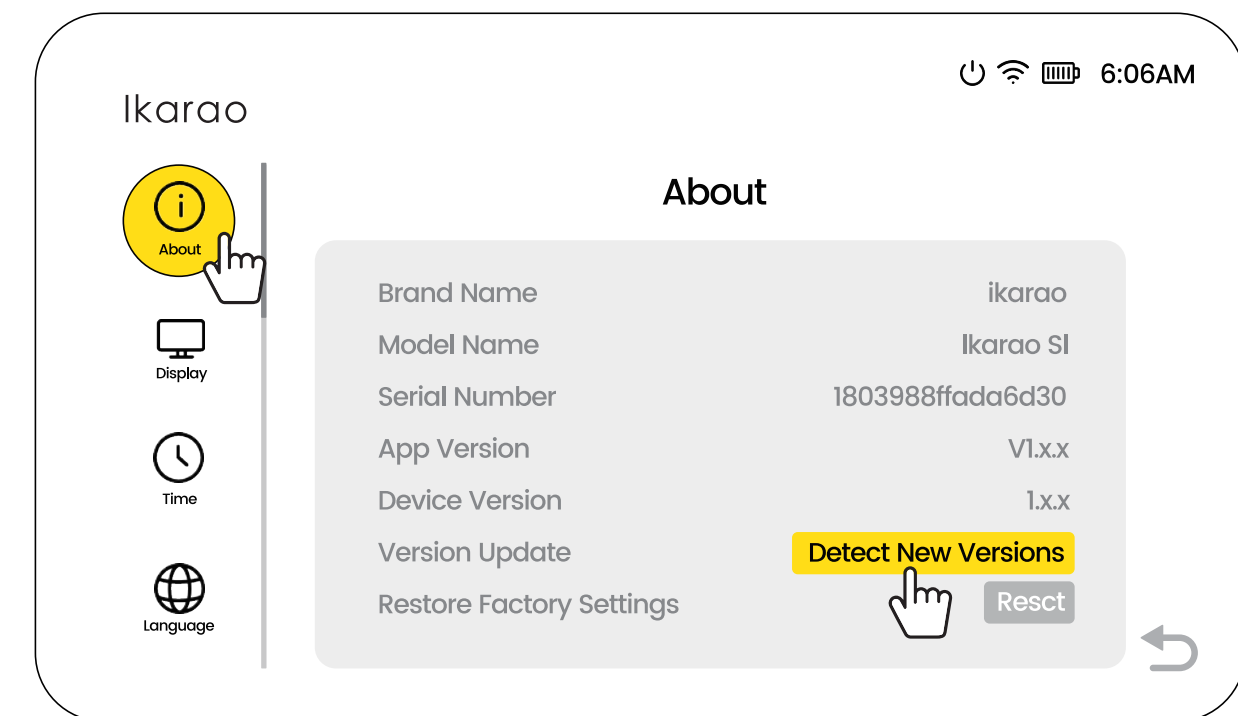

NOTE: Ensure speaker power is above 50% or plugged in.

CUSTOMER SERVICE



1 Click **Service**

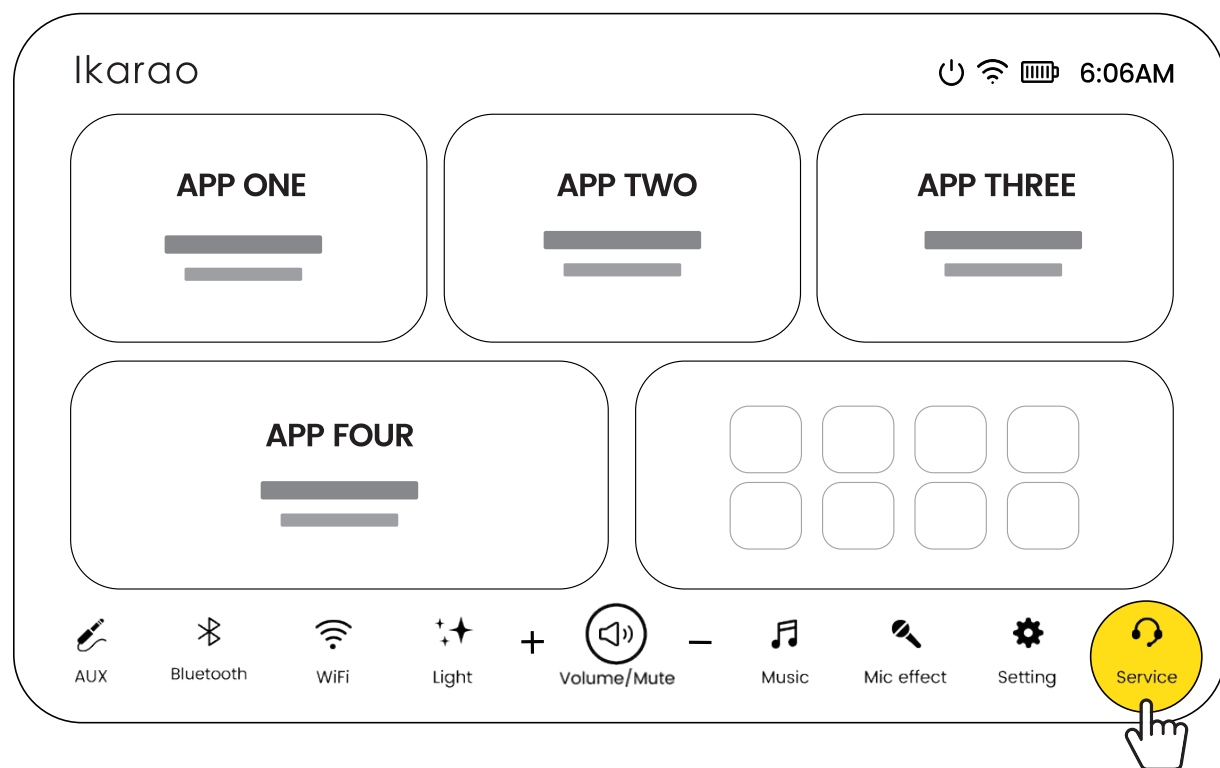

2 Fill in your information

Ikarao Service

If you have any suggestions of this product kindly leave your precious advice here, and your feedback will encourage us improve our product preferably.

way 1 :



way 2 :

Model Number

Shell s1

Tel

Email

Question or Suggestion

USE CARRYING STRAP



1 Take out Carrying Strap

2 Buckle up Carrying Strap

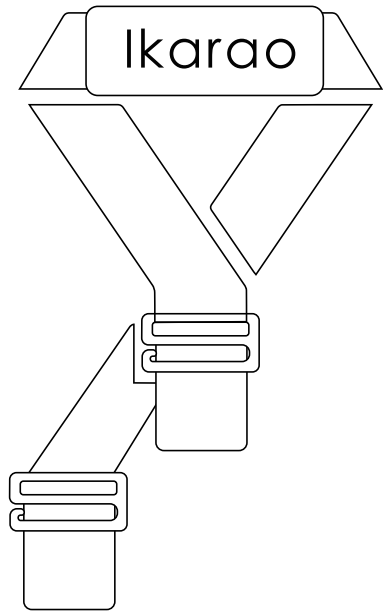

Carrying Strap

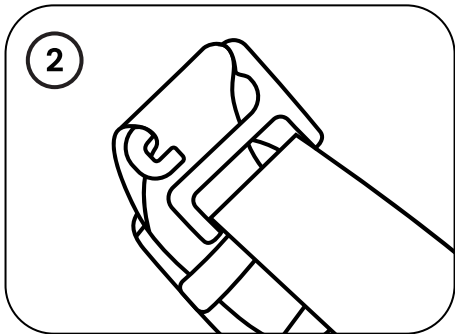
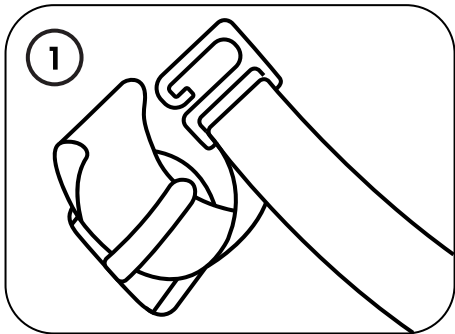

NOTE: Please fasten the strap to ensure your speaker can be carried safely.

IMPORTANT SAFETY INFORMATION

Safety Instructions Before Using the Machine:

- 1 Please read and retain this user manual.
- 2 Do not block the speaker's ventilation openings or sound channels with objects.
- 3 Avoid using the machine at high volumes for prolonged periods to prevent damage.
- 4 Use compliant accessories, internal batteries must not be removed or replaced by the end user.
- 5 The operating temperature should be between 0°C and 40°C.
- 6 Do not expose the device to damp or high-temperature environments such as puddles, sunlight, or open flames to avoid the risk of electric shock or explosion.
- 7 Unplug the machine during thunderstorms or if it will not be used for an extended period.
- 8 Do not forcibly insert a TF card or SD card into the slot. Insert the card in the correct sequence to avoid malfunction.
- 9 Do not use any corrosive or oily cleaners to clean the machine.
- 10 To maintain the machine's performance and battery life, fully charge it at least once every three months.



CERTIFICATION AND COMPLIANCE



FCC Statement

This device complies with Part 15 of the FCC Rules. Operation is subject to the following two conditions:

- 1) This device may not cause harmful interference, and
- 2) this device must accept any interference received, including interference that may cause undesired operation.

FCC WARNING

Changes or modifications not expressly approved by the party responsible for compliance could void the user's authority to operate this equipment.

Radiation Exposure Statement(Only for speaker)

This equipment complies with FCC radiation exposure limits set forth for uncontrolled environment. This equipment should be installed and operated with minimum distance of 20 cm between the radiation & your body.



Dongguan Aika Electronic Technology Co., Ltd. declares that this product is in compliance with Directives 2014/53EU and all other applicable EU directive requirements. The complete declaration of conformity can be found at: www.ikarao.com



The Bluetooth® word mark and logos are registered trademarks owned by Bluetooth SIG, Inc. and any use of such marks by Dongguan Aika Electronic Technology Co., Ltd. is under license. Other trademarks and trade names are those of their respective owners.

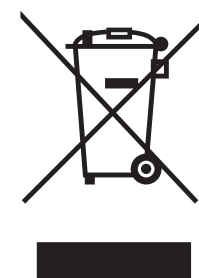

This symbol means the product must not be discarded as household waste, and should be delivered to an appropriate collection facility for recycling. Follow local rules and never dispose of the product and rechargeable batteries with normal household waste. Correct disposal of old products and rechargeable batteries helps prevent negative consequences for the environment and human health.

For FAQs and more information, please visit

WWW.IKARAO.COM/PAGES/SUPPORT



@ikaraoofficial @IKARAO



@IKARAO



@IKARAO



@ikaraoofficial